

HOSPITAL OF THE UNIVERSITY OF PENNSYLVANIA

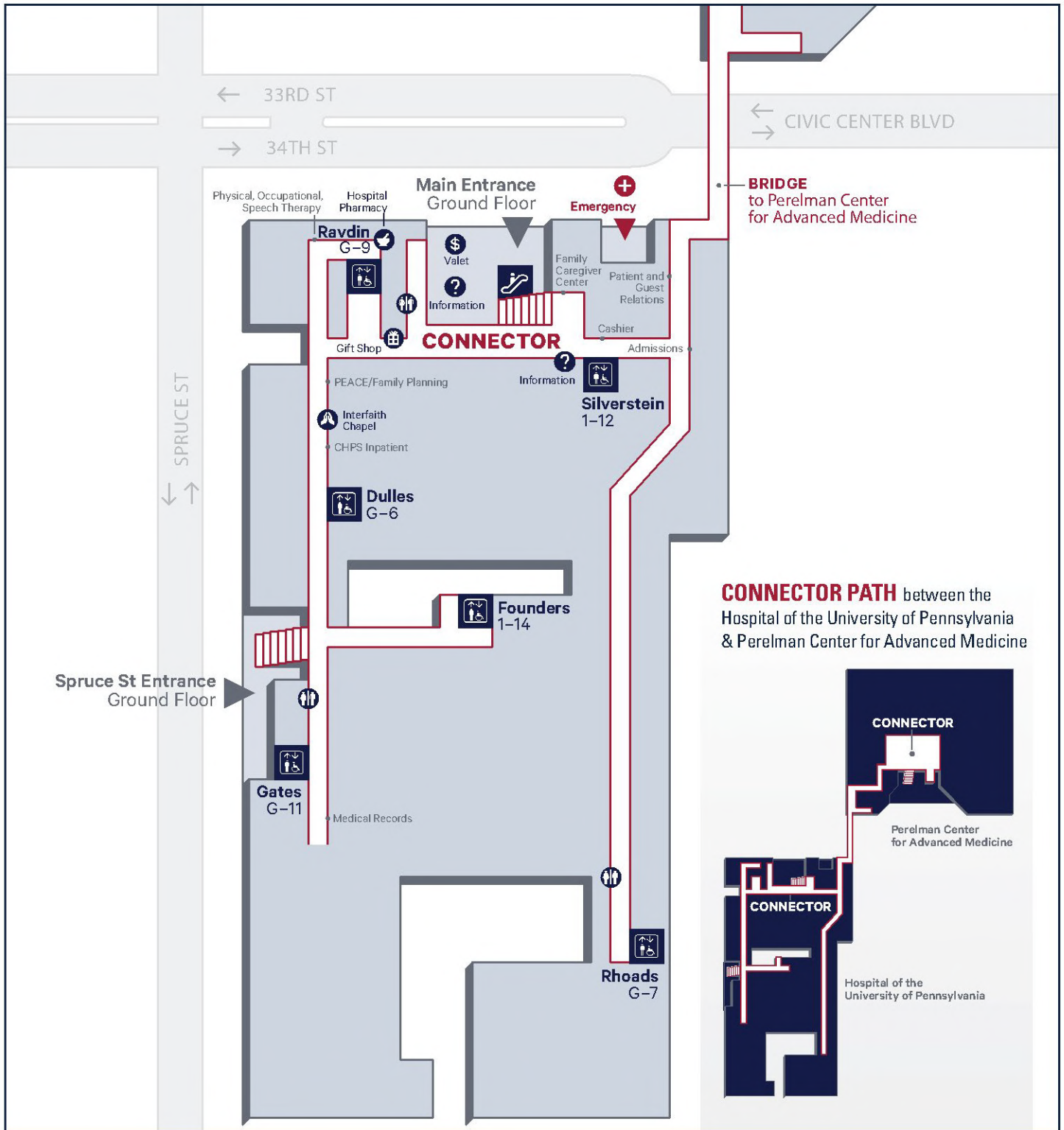

DIRECTORY

CONNECTOR (FIRST FLOOR)

- Admissions
- Cashier
- CHPS Inpatient
- Family Caregiver Center
- Gift Shop
- Hospital Pharmacy
- Interfaith Chapel
- Medical Records
- Patient and Guest Relations
- PEACE/Family Planning
- Physical, Occupational, Speech Therapy
- Urogynecology

HOSPITAL DESTINATIONS

| | |
|--|-------------------------------|
| Antenatal Testing | Silverstein Elevator |
| Apheresis and Infusion | Ravdin Elevator |
| Cafeteria | Founders/Silverstein Elevator |
| Cardiac Cath Lab | Founders Elevator |
| Coagulation Lab | Founders Elevator |
| Dickens Center for Women's Health | Gates Elevator |
| Electrophysiology Lab | Founders Elevator |
| Genetic Counseling | Silverstein Elevator |
| Inpatient ECHO | Rhoads Elevator |
| Intensive Care Nursery | Silverstein Elevator |
| Labor and Delivery | Ravdin Elevator |
| Maternal Fetal Medicine | Silverstein Elevator |
| Neurodiagnostic Lab | Ravdin Elevator |
| Obstetrical Ultrasound | Silverstein Elevator |
| Occupational Medicine | Ravdin Elevator |
| Pathology | Founders Elevator |
| Perinatal Evaluation | Ravdin Elevator |
| Phototherapy | Gates Elevator |
| Pre-Op Registration | Ravdin Elevator |
| Radiology | Dulles Elevator |
| Second Stage Recovery | Ravdin Elevator |
| Sleep Medicine | Gates Elevator |
| Surgical Family Lounge | Dulles Elevator |
| Travel Medicine | Ravdin Elevator |
| Valet | Ravdin Elevator |

PATIENT ROOMS

| | |
|-------------------------------|----------------------|
| 560-591 | Founders Elevator |
| 630-648 | Ravdin Elevator |
| 650-671 | Dulles Elevator |
| 701-722 | Silverstein Elevator |
| 801-826 | Silverstein Elevator |
| 875-886 | Founders Elevator |
| 901-930, 951-955 | Silverstein Elevator |
| 931-949, 956-958 | Ravdin Elevator |
| 960-983 | Founders Elevator |
| 1001-1030 | Silverstein Elevator |
| 1035-1056 | Rhoads Elevator |
| 1060-1084 | Founders Elevator |
| 1101-1130 | Silverstein Elevator |
| 1160-1186 | Founders Elevator |
| 1201-1230 | Silverstein Elevator |
| 1260-1289 | Founders Elevator |
| 1460-1489 | Founders Elevator |
| 2001-2022 | Rhoads Elevator |
| 3001-3026 | Rhoads Elevator |
| 4001-4026 | Rhoads Elevator |
| 5001-5024 | Rhoads Elevator |
| 6001-6026 | Rhoads Elevator |
| 7001-7026 | Rhoads Elevator |

CAFETERIA

- **Founders Building** – 2nd Floor
 - » Breakfast served 6 am to 10:30 am
 - » Lunch/Dinner served 10:30 am to 7 pm
 - » Grab 'n Go items available until Midnight

A salad bar, short order grill and deli, as well as a variety of freshly baked cookies and desserts are featured daily. Takeout items are available throughout the day.

VENDING AREAS – OPEN 24 HOURS

- **Rhoads Pavilion** – Basement
- **Founders Building** – 3rd Floor
- **Founders Building** – 5th Floor, near the Surgical Intensive Care Unit waiting area

COFFEE CARTS

- **Founders Building** – 2nd Floor
 - » Open: 6 am to 2:30 pm
- **Perelman Center** – Atrium
 - » Open: 7 am to 3:30 pm